

NEW PLACES 2019

location 3: MZ Klisa

morphology and urbanism

concept explanation

multifunctionality explanation

added and removed elements

floorplan 1:200

construction details

axonometric drawing 1:200

visualisation



From morphology itself and program distribution it is evident, that this suburban area has no gravitational center, no real public space. It lacks a common area, a square.

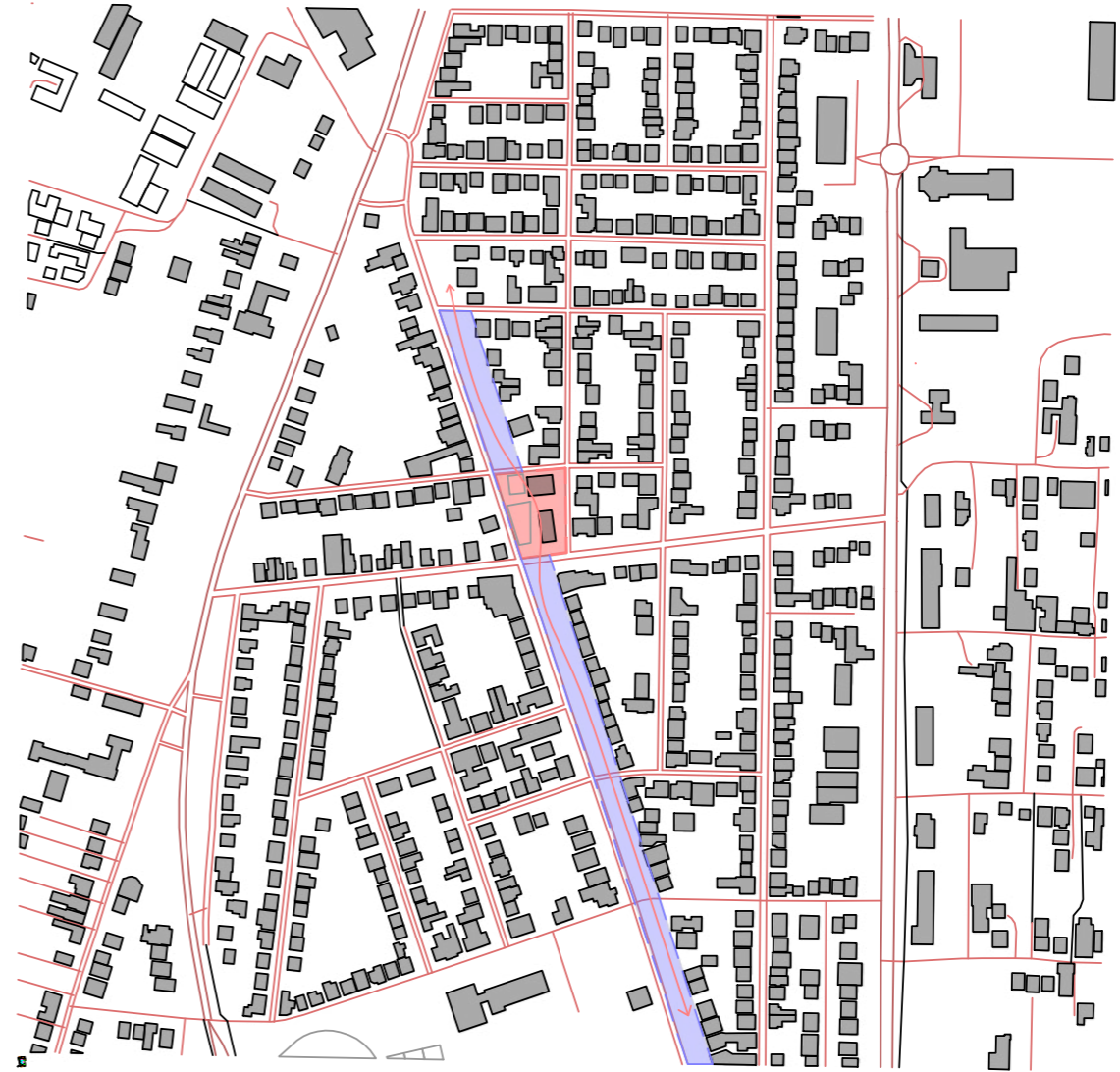

Our location is placed in the middle of a beautiful green belt that connects the whole neighbourhood. It is clear that no matter what our intervention will be, the place must stay also a park, a green area. The idea for future planning (outside the competition) would be to connect the neighbourhood with a green pathway along the tree avenues with sport areas, urban gardens and parks. That is why we conceived our intervention in a way that would fit in this way of future planning.

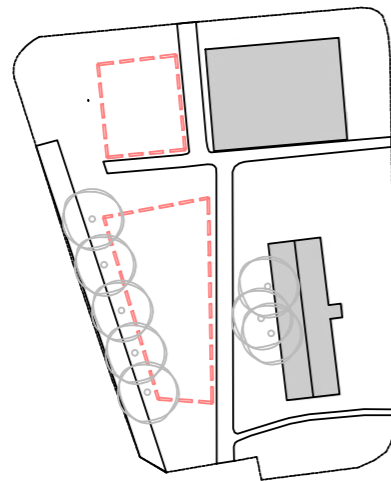

Before our intervention, activities on location are not connected, although they seem to function well on their own. However, the space is fragmented, without integrity, without identity. If we aim for it to become a public space of gathering, the space must become a place, it must function as a whole and at the same time the activities there can be separatable.

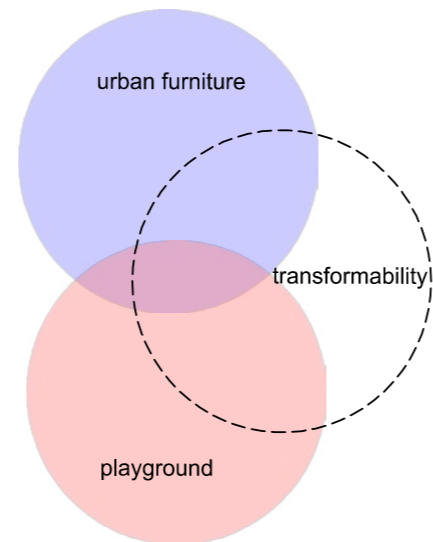

Since the current, really evident connecting activity on this location is play, we decided to emphasize it to the extent where the boundary between playground and urban furniture is no longer visible. Our one connecting element can be used both as a play tool or just for observing and socialising. At the same time we want it to be neutral in its form, so it is versatile for more uses, it can be easily built and maintained.

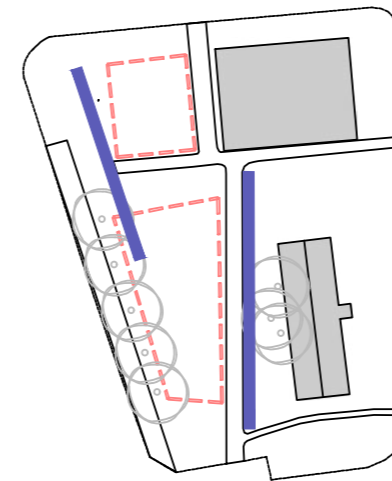

New longitudinal structures are placed in such way that they divide space without making a solid boundary, they create three segments out of two, so they enable us to place a new, multifunctional space, which ultimately functions as a square.

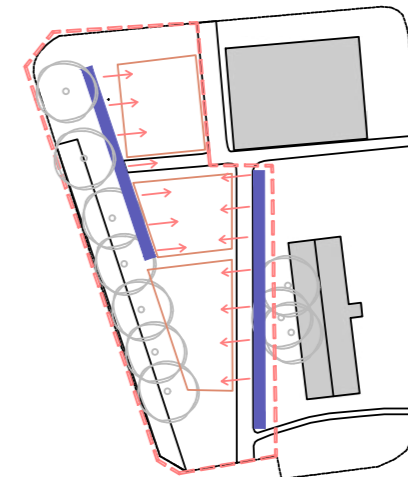

Structure interacts with all three segments of the place. It enables a sitting area to watch a basketball game, a quiet shaded area for the parents to watch their kids play, and double oriented spectating area meant to watch an event in the middle square.

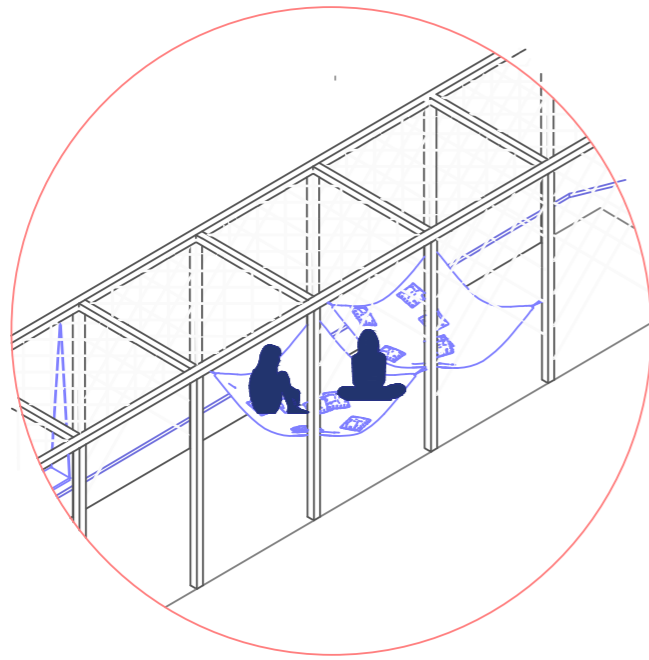

Hammocks can be used for resting or for activities such as debating, having lunch, or even workshops can take place hanging in the air.

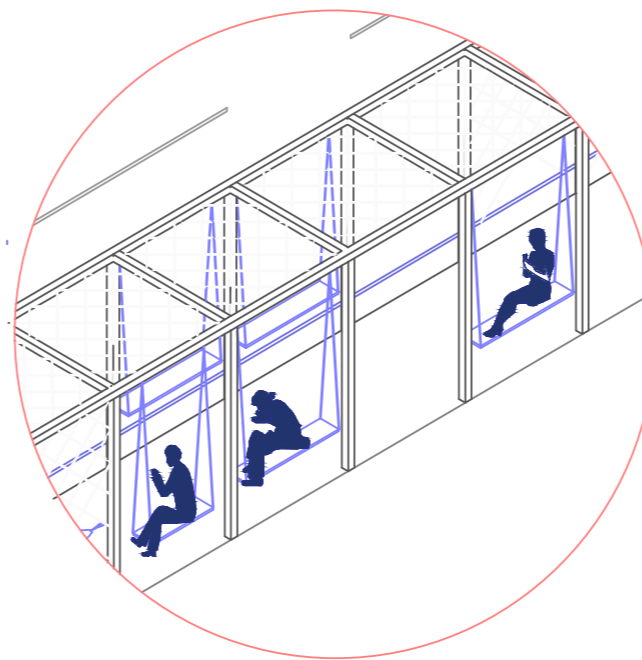

swings function as benches that evoke a childhood memory to visitors. They invite them to be part of the play, part of the movement. At the same time the shade of ivy plants offers them privacy and serenity.

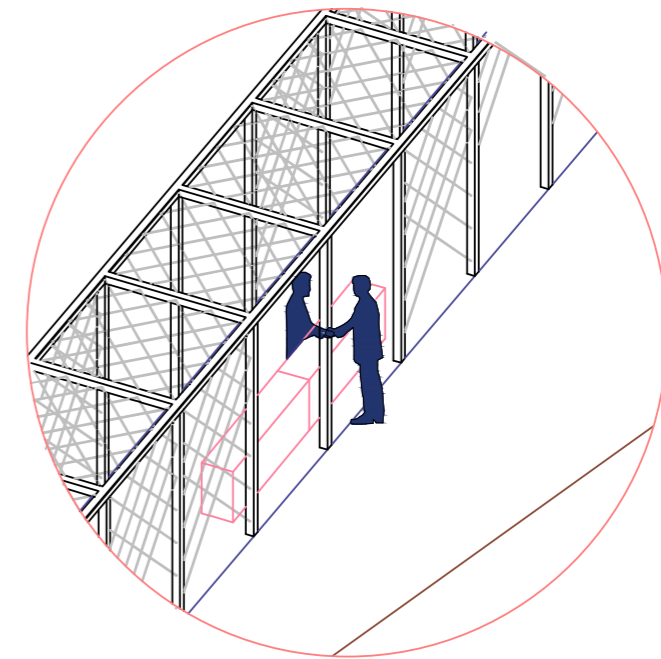

With placing additional tables, a part of the structure can become market, a bookstore or a workshop space.

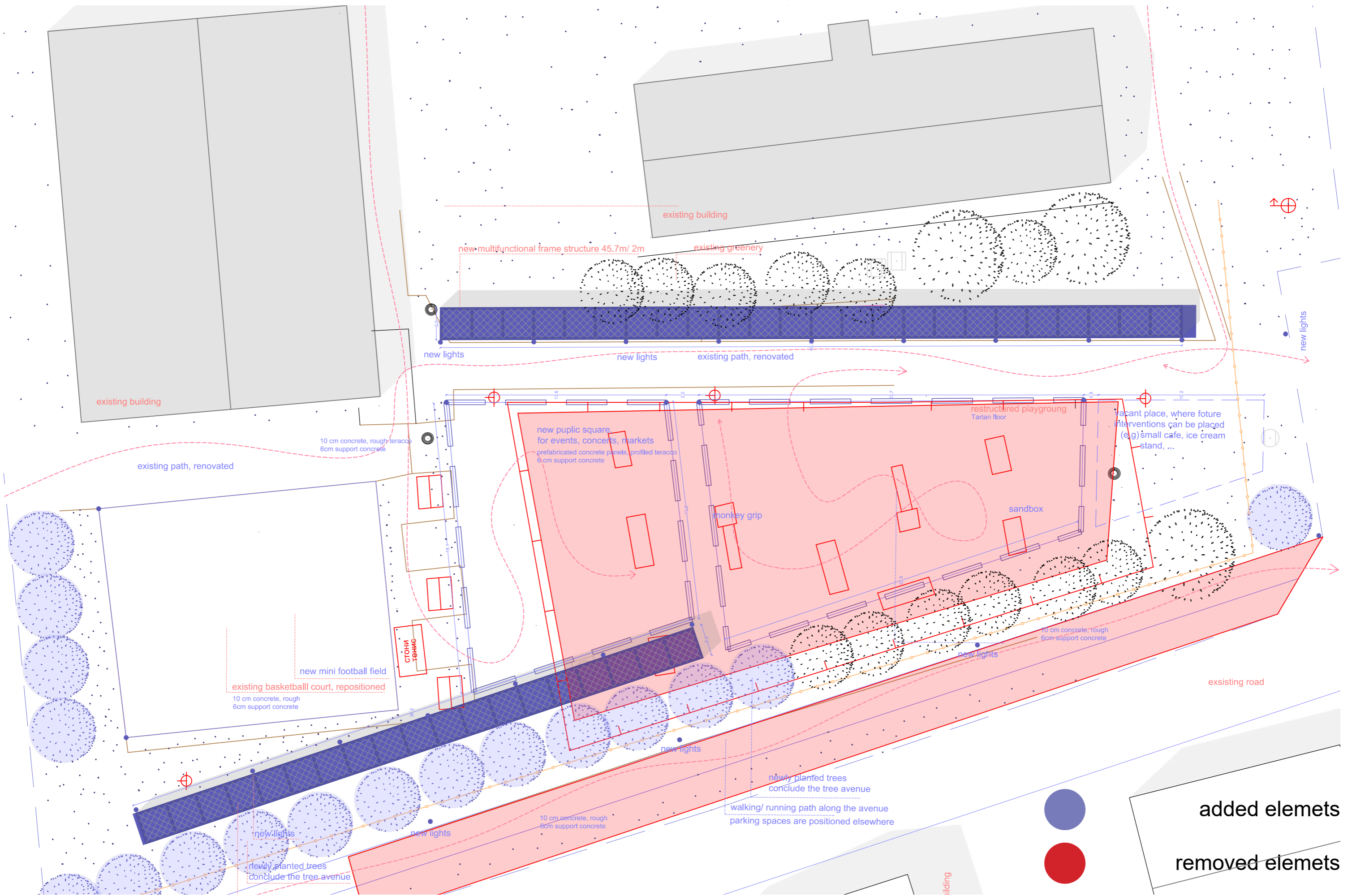

added elemets
 removed elemets
 added and removed elemets

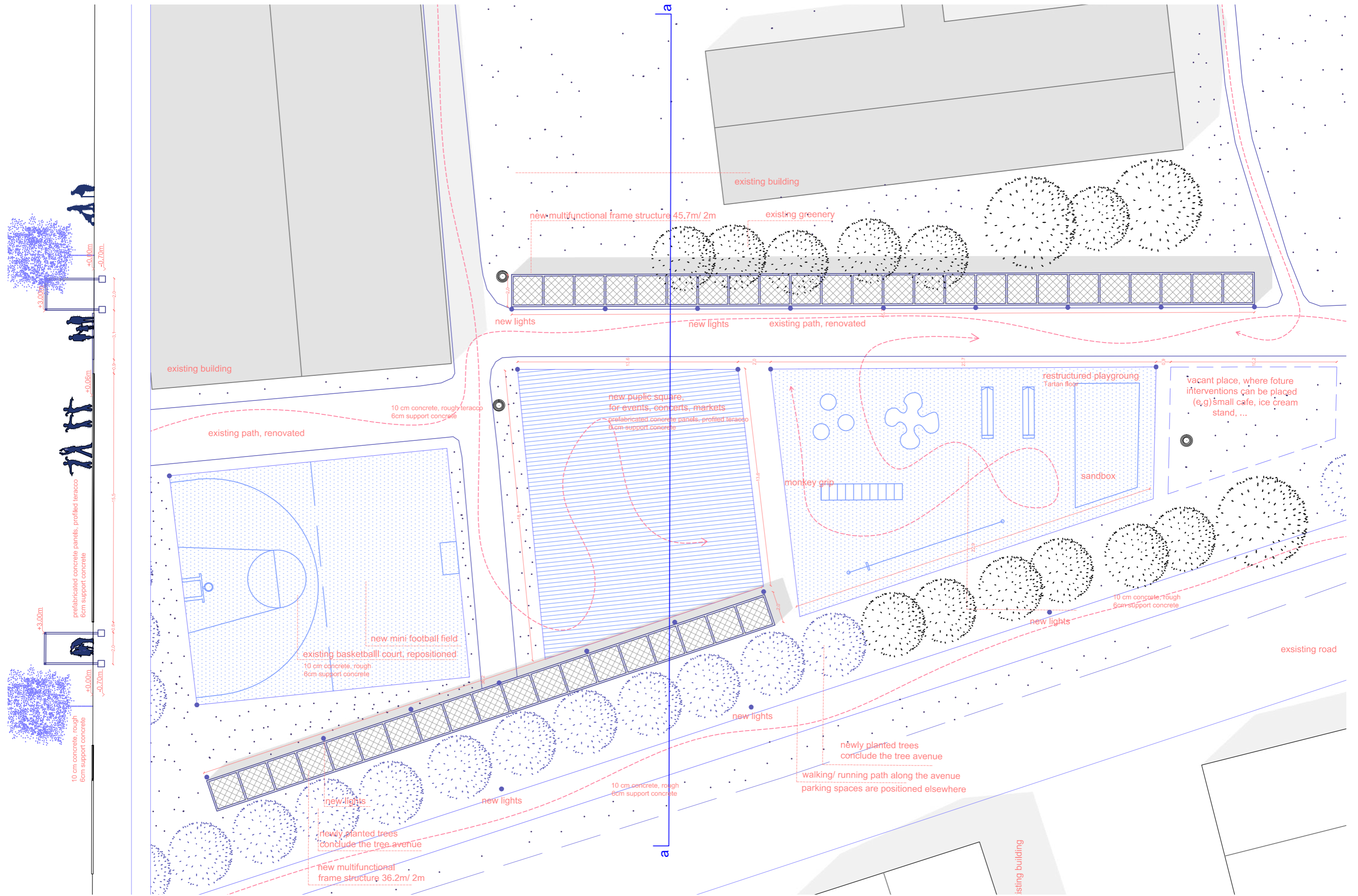

floorplan 1:200

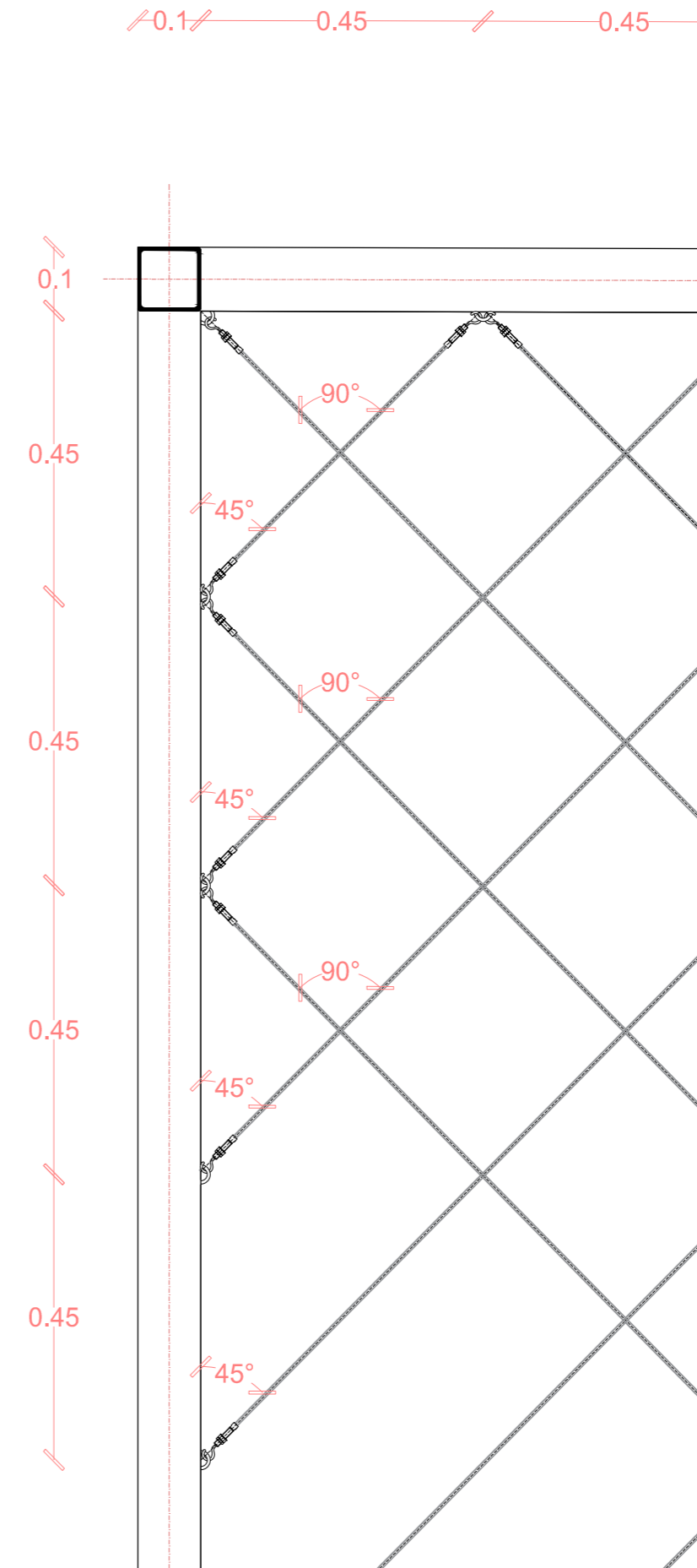
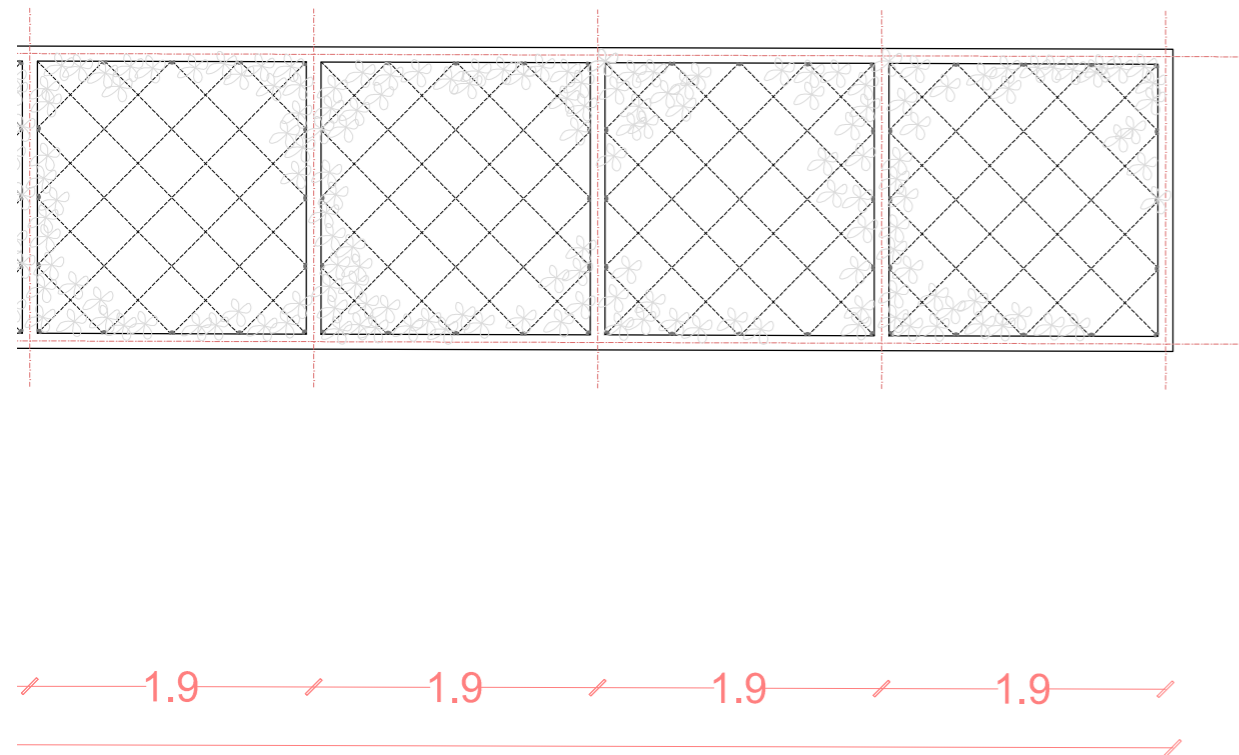
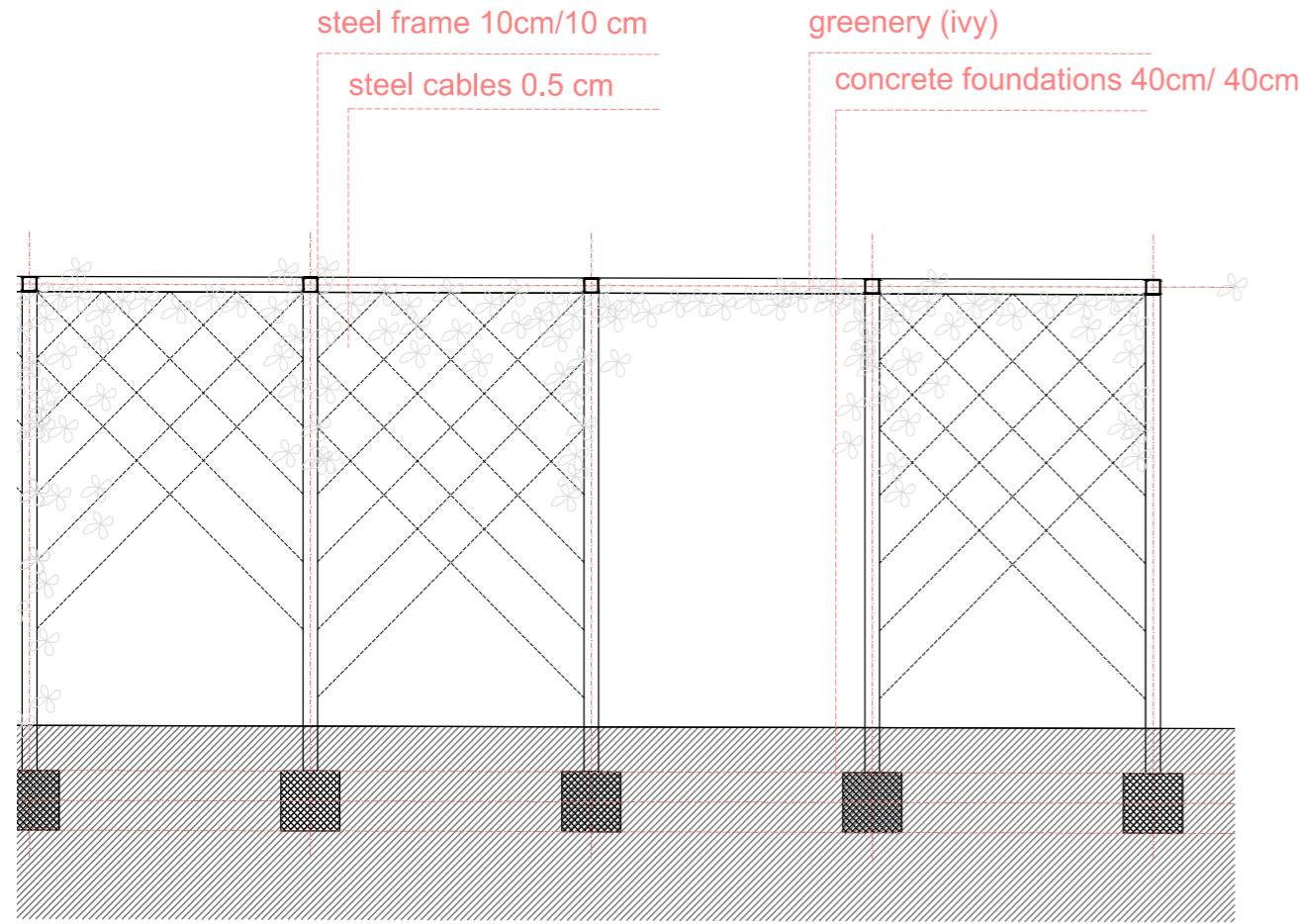

On the location of MZ Klisa it is proposed to build two (2) new pavillions, that have a function of urban furniture, event space or space for workshops/meetings. Furthermore, they make space intergral and connected.

STRUCTURE:To achieve a transperent, lightweight effect of the structure, is the construction made of welded stainless steel, with white, anti-corossion coating. For horisontal stability, as well as for shading (together with ivy greenery) steel cables are mounted onto frames. Joints of the cables can manually be tightened, loosened or removed for easy assembly and maintance.

FLOOR:Main path is renovated with terracco concrete, the playground is resized, renovated and floored with soft tartan material. On basketball field only maintance works are made. In the plac of previous parking a new walking path is proposed to connect the location with the surrounding green belt. For easy maintance it is made of rough concrete. A new miltifunctional square is proposed between basketball lcourt and playground. It is covered with prefabricated concrete panels, that are profiled upo casting to prevent a slippery surface.

GREENERY:To conclude the avenue, new trees are planted. New ivy plants are planted in concrete pots by the steel pavillions. Ivy grows on steel cables and connests pavillions with greenery while also providing shading.

MATERIALS LIST:

- 1) steel profile 100/100/5 mm: 523,8 m
- 2) steel cable (5mm): 900 m
- 3) concrete for founations:90m3
- 4) floor concrete:412m2
- 5) prefabricated concrete panels: 216 m2
- 6) tartan floor: 271 m2
- 7) planted trees: 16 pcs
- 8) ivy plants (with concrete pots):30 pcs

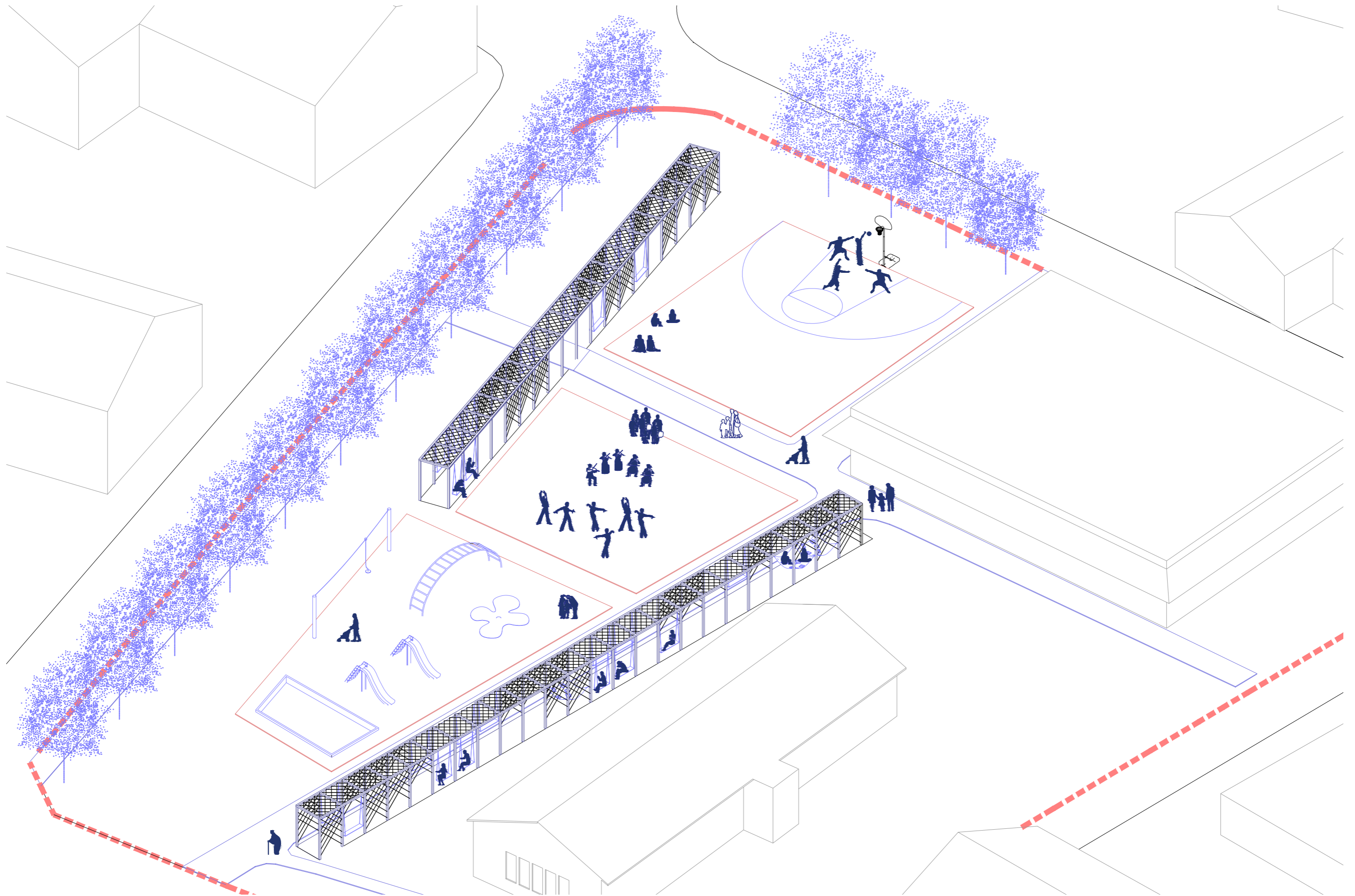

axonometric drawing 1:200



visualisation

